

Getting started as a student with learn.gold

Learn.gold is the Virtual Learning Environment (VLE) at Goldsmiths which you'll use in various different ways to support your studies.

This printable guide from the Teaching & Learning Innovation Centre (TaLIC) will help you find learn.gold, log in and locate our **online help area** which has a mix of videos, howto guides and activities to get you started.

First, open a web browser...

Type **learn.gold.ac.uk** into the address bar and the site home page will load, it will look something like the screenshots below:

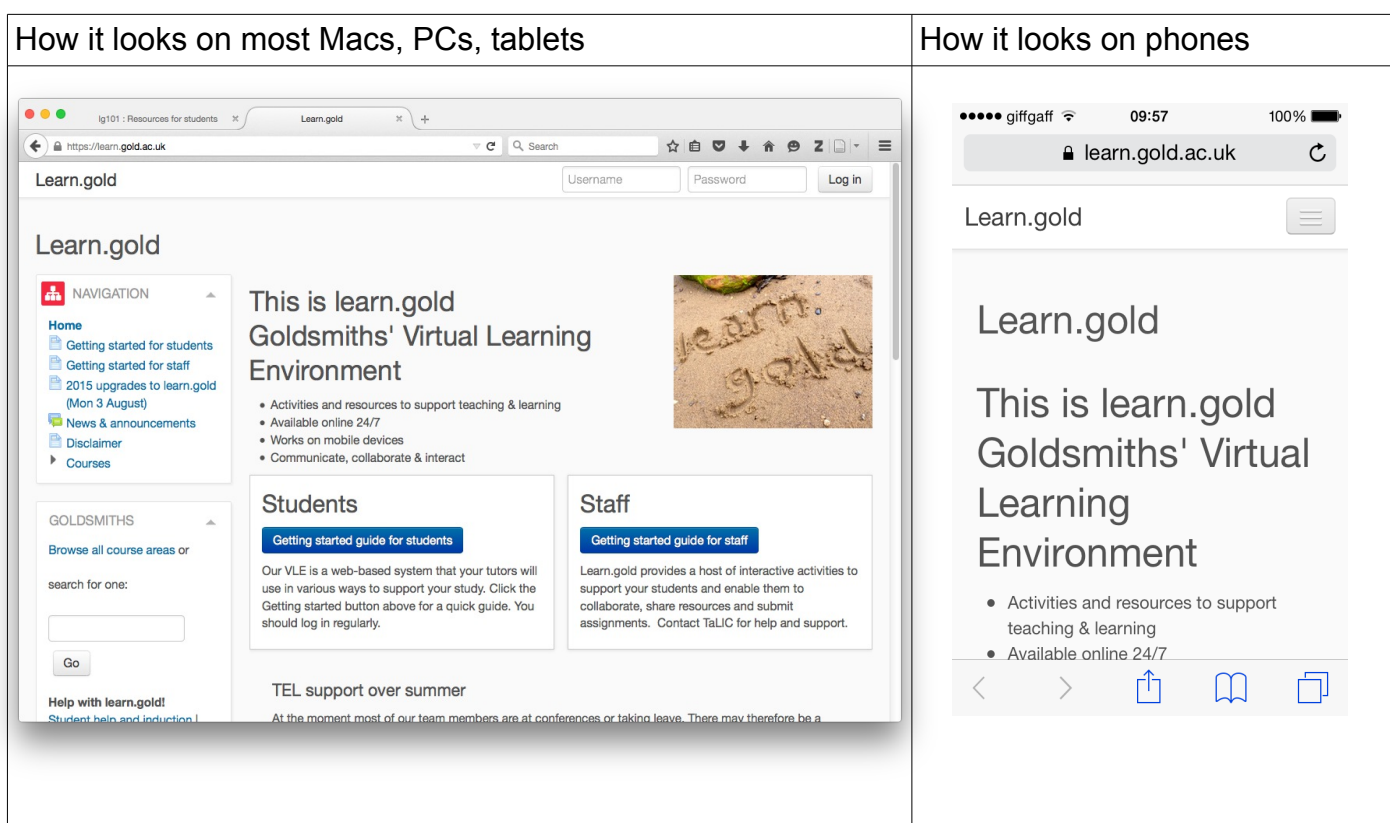

If this is your own device, it's probably worth adding this to your favourite bookmarks at this point to save time in future.

Log in

Look for the login box with Username and Password, usually at the top right. On a small screen it may collapse to save space, so if you just see a small box with lines – click that to show the full login box.



Type your username in – this will look something like this: pcasi010 (it's the same username you use when you log in to your Goldsmiths email). Don't include the 'campus' part.

Be careful entering your password, it's case sensitive. If it doesn't seem to work, try again and make sure you didn't accidentally have Caps Lock enabled.

Can't log in?

If you've forgotten your username or password, or if it keeps going back to the login screen, please contact IT Services as they look after usernames and passwords at Goldsmiths. They have a helpdesk on the first floor of the library or see the [IT web pages](#).

If learn.gold seems to get stuck on a profile page, or a blank screen – please contact the IT helpdesk. Email tel@gold.ac.uk if they can't spot the problem.

What to do when you log in for the first time

When you log in, you'll see your personal home page called My Home. This is a dashboard with links to your **course areas** – the places containing activities and resources for your modules. The first time you log in it may not have any course areas – don't worry, this is normal. We'll cover this later.

At the top is a welcome panel. Read this and click on the Student help button (shown below).

A screenshot of the 'My home' dashboard on learn.gold. The page has a header 'old: My home'. On the left is a calendar for August 2015. The main content area has a 'WELCOME TO LEARN.GOLD' section with a 'WELCOME. PLEASE TAKE A FEW MOMENTS TO FAMILIARISE YOURSELF WITH THE HELP AND SUPPORT RESOURCES BELOW.' message and a hand icon pointing right. Below this are two columns: 'Students: new to learn.gold?' and 'Staff: join the staff hub'. The 'Students' section has a 'Student help' button. A callout box with the text 'look for the Student help button and click it' has an arrow pointing to the 'Student help' button. On the right is a 'LOGGED IN USER' section with a profile picture of Pete Casio and a search bar. At the bottom right are links for 'Help with learn.gold!', 'Take me to...', and 'Site home | Mahara | Turnitin'.

When you click the Student help button, you should see another page with a join button, similar to the screenshot below - click the join button.

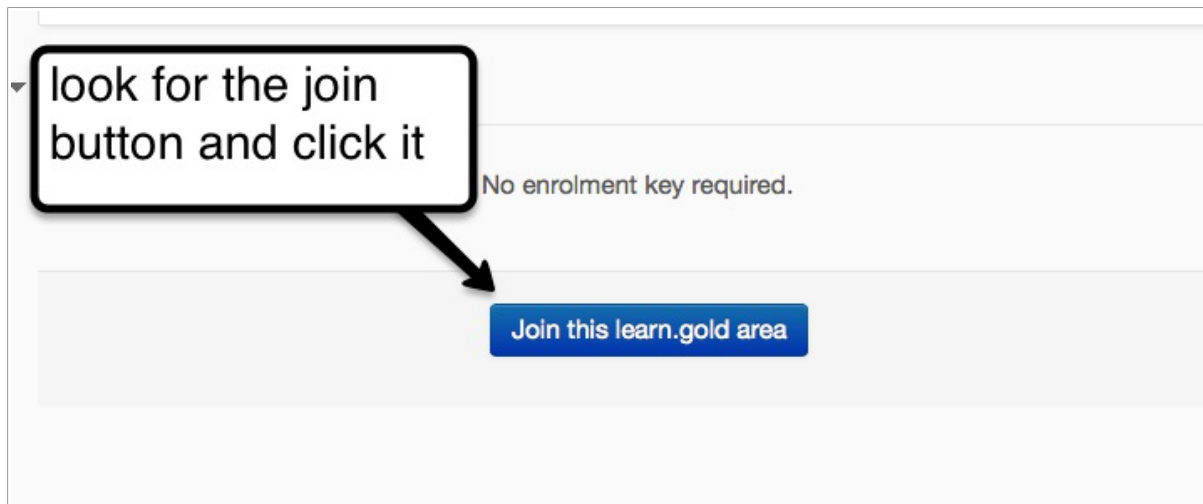

You should now be able to see the Student help area and it will appear on your My Home next time you log in.

Read the Essentials Book resource

Have a look through the Student Help area. This is a typical course area – it contains a number of sections on different topics, with different icons and links against them.

You don't need to read it all straight away – you can refer back to it when you need to, for example when submitting assignments.

You should **definitely** look at the Book resource in the Essentials section – this introduces learn.gold and shows you how to navigate and find course areas and join them. Click on the link against the green Book icon (see below).

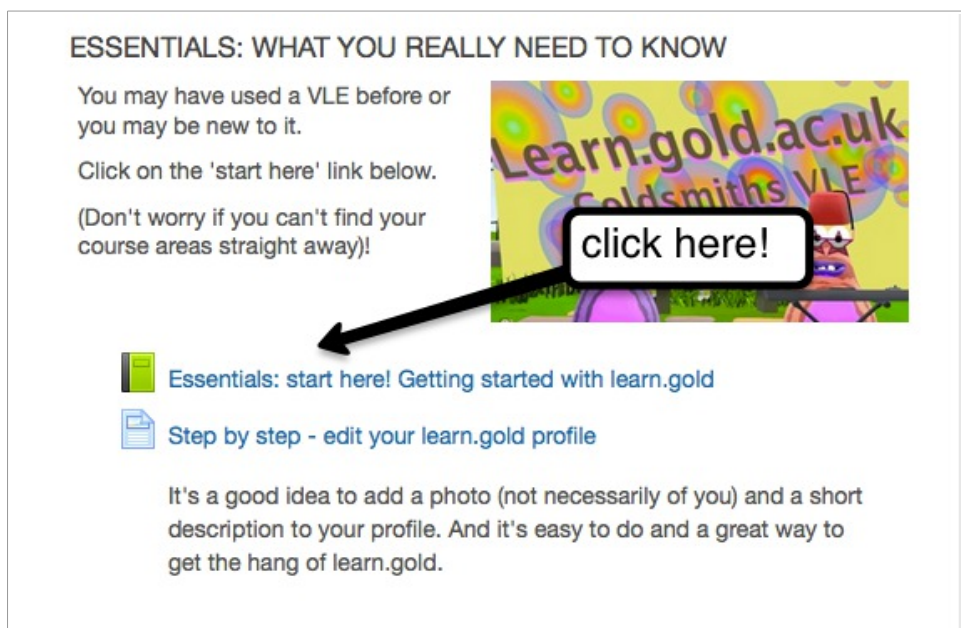

Within the Book, you can use the forward and back buttons, or use the Table of Contents to move between the pages. The screenshot below shows the Essentials book:

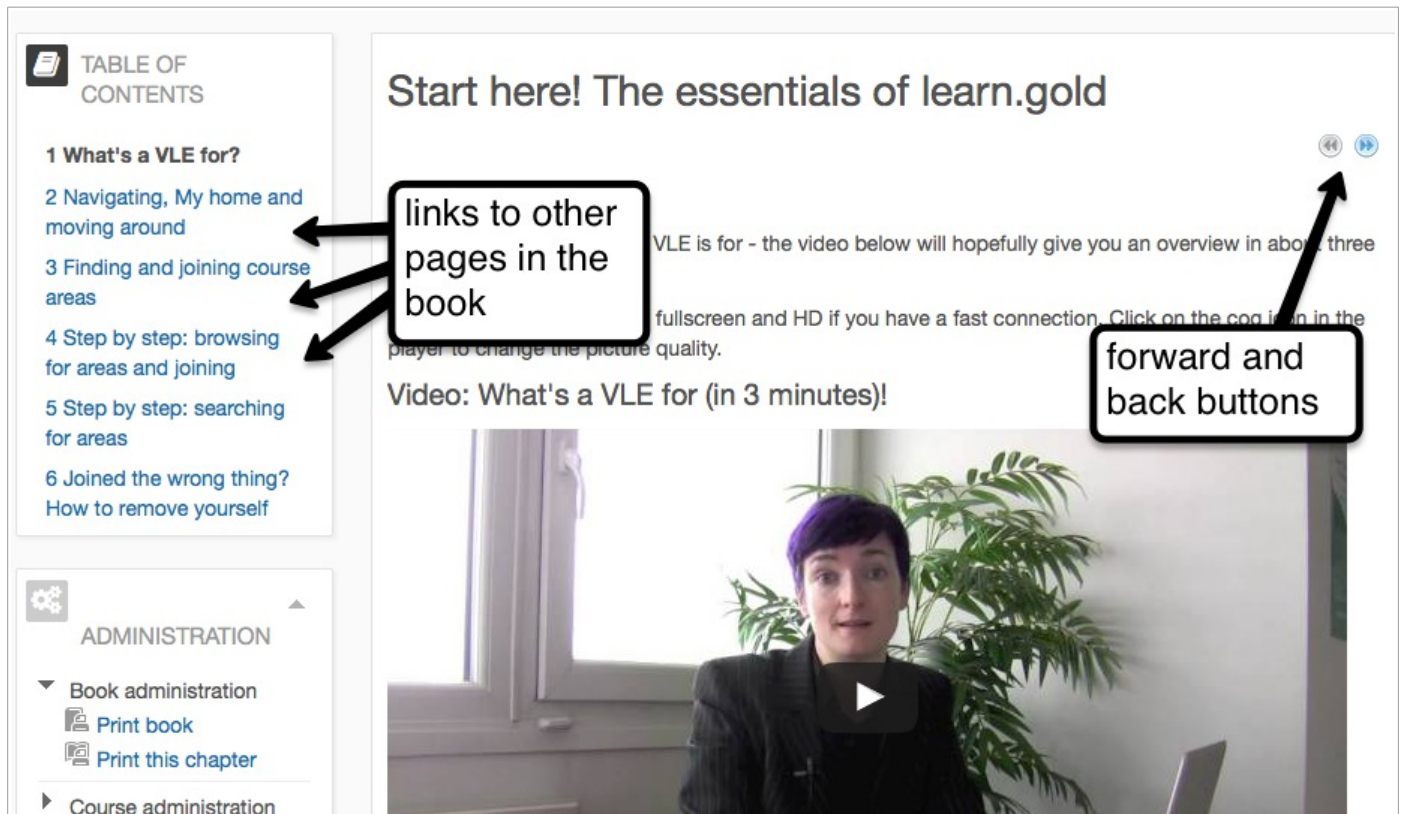

Navigating around with the Breadcrumb Trail

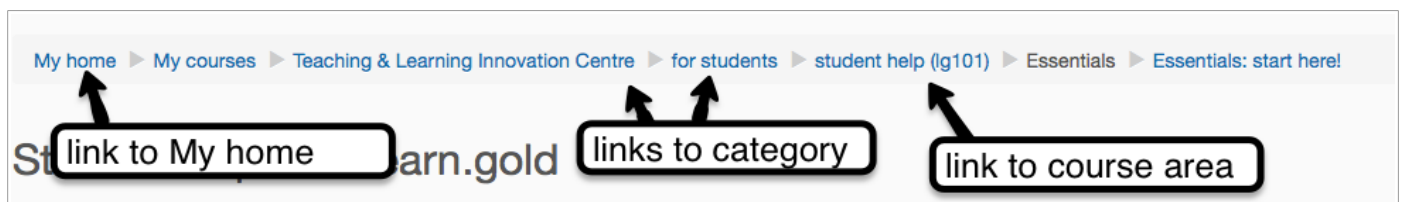

Learn.gold has a **breadcrumb trail** - a navigation bar at the top of each page which shows where you are within learn.gold. You can click on the links within the breadcrumb trail - this is a quick way to navigate around.

For example if you're in the Essentials Book, you can get back to the student help area using the link - or just go straight back to My home. The category links will list all the course areas for that category.

Useful tips

- The **Student help & resources** menus at the very top of learn.gold will take you direct to the Student help area or our list of resources for students. You'll see there are loads of useful materials to support your studies (you need to be logged in to see it)

- **My home** is personalised to you – you can return to this whenever you are logged in (via the Breadcrumb trail). You can also customise it.
- Learn.gold has lots of separate course areas. There is usually one per programme module, plus some general ones – such as departmental 'virtual offices'. You will generally need to join a selection of these for your studies. You are also free to look at other course areas on learn.gold too. Some need an enrolment key (a password basically) to get in. Your tutor or department will supply this.
- If you can't find your course area, contact your department. It may not be ready yet, depending when you are looking for it.

For help with your course area – always contact your tutor or department first. They may refer you on to us if they can't help.

When you're through – always log out

At the top right of the page, click on your name. A small menu of options will appear. Click on Log out.

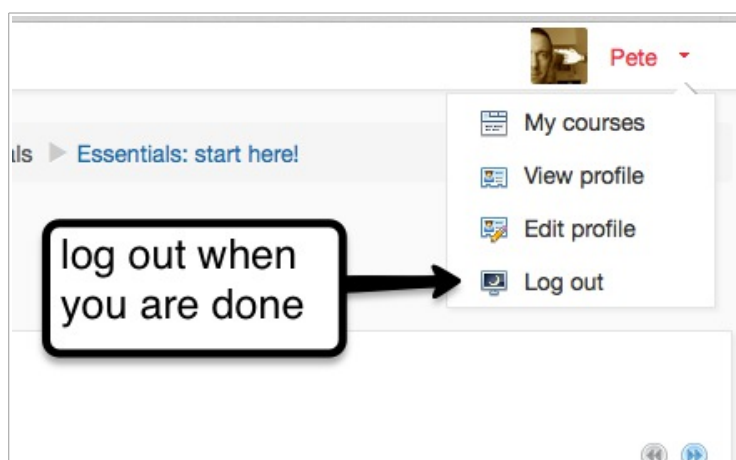

This guide was produced by the Goldsmiths TEL team (Technology Enhanced Learning) We're part of TaLIC

Email: tel@gold.ac.uk

We hope you enjoy using learn.gold.



Scan the QR-CODE to go straight to the student help area (you'll need to log in when prompted and click the join button)